

# JOINT PUBLIC NOTICE

March 19, 2018

United States Army  
Corps of Engineers  
New Orleans District  
Regulatory Branch  
7400 Leake Avenue  
New Orleans, Louisiana 70118

State of Louisiana  
Department of Environmental Quality  
Office of Environmental Services  
Post Office Box 4313  
Baton Rouge, Louisiana 70821-4313

(504) 862-1217  
Project Manager  
Kenny Blanke  
[Kenneth.G.Blanke@usace.army.mil](mailto:Kenneth.G.Blanke@usace.army.mil)  
MVN 2017-1480-CQ

(225) 219-3225  
Project Manager  
Ms. Elizabeth Hill  
WQC Application Number  
WQC 180312-06

Interested parties are hereby notified that a permit application has been received by the New Orleans District of the U.S. Army Corps of Engineers pursuant to: [X] Section 10 of the Rivers and Harbors Act of March 3, 1899 (30 Stat. 1151; 33 USC 403); and/or [X] Section 404 of the Clean Water Act (86 Stat. 816; 33 USC 1344).

Application has also been made to the Louisiana Department of Environmental Quality, Office of Environmental Services, for a Water Quality Certification (WQC) in accordance with statutory authority contained in LRS30:2074 A(3), and provisions of Section 401 of the Clean Water Act (P.L.95-17).

## **DREDGING FOR CONSTRUCTION OF SAFE HARBOR AND SPOIL PLACEMENT FOR BERM AND CAMPSITE ALONG BAYOU CHENE IN TERREBONNE PARISH**

**NAME OF APPLICANT:** Mr. Harry K. Hoffpauir, 995 Utah Street, Berwick, Louisiana 70342.

**LOCATION OF WORK:** Located on an approximate 1.4-acre site, located along the left descending bank and east of Bayou Chene, located south of Amelia, Louisiana, located in Terrebonne Parish, as shown on the enclosed drawings (Latitude 29.615 N Longitude -91.116111 W). This project is located in the Terrebonne Basin (West Central Louisiana Coastal HUC 08090302).

**CHARACTER OF WORK:** The applicant is requesting a Department of the Army permit authorization for the dredging of waterbottoms and wetlands along the left descending bank of Bayou Chene to construct an approximate 0.6 acre safe harbor. The project will entail the placement of dredged material as fill for the construction of a berm to protect the proposed safe harbor and allow for the construction of an approximate 20' x 20' elevated campsite. Approximately 3,457 cubic yards of native material would be excavated and placed in jurisdictional areas as a result of project implementation. Approximately 1.16 acres of jurisdictional fresh marsh with some mixed forested wetland habitat and 0.25 acre of jurisdictional Other Waters of the United States (OWOUS) would be permanently impacted by the project as a result of dredging and fill placement. The applicant has claimed that the project has been designed to avoid and minimize direct and secondary adverse wetland impacts to the maximum extent practicable. The applicant has also claimed that the site was selected due to the limited number of large trees (primarily black willow) that would need to be impacted. The applicant is proposing to utilize best management practices during and after the construction phase of the project. The applicant is proposing to compensate for the

unavoidable impact by purchasing mitigation credits from an approved mitigation bank.

The comment period for the Department of Army Permit and the Louisiana Department of Environmental Quality will close in **20 days** from the date of this joint public notice. Written comments, including suggestions for modifications or objections to the proposed work, stating reasons thereof, are being solicited from anyone having interest in this permit and/or this WQC request and must be mailed so as to be received before or by the last day of the comment period. Letters concerning the Corps of Engineers permit application must reference the applicant's name and the Permit Application Number, and be mailed to the Corps of Engineers at the address above, **ATTENTION: REGULATORY BRANCH**. Similar letters concerning the Water Quality Certification must reference the applicant's name and the WQC application number and be mailed to the Louisiana Department of Environmental Quality at the address above. Individuals or parties may request an extension of time in which to comment on the proposed work by writing or e-mailing the Corps of Engineers Project Manager listed above. Any request must be specific and substantively supportive of the requested extension, and received by this office prior to the end of the initial comment period. The Section Chief will review the request and the requestor will be promptly notified of the decision to grant or deny the request. If granted, the time extension will be continuous to the initial comment period and, inclusive of the initial comment period, will not exceed a total of 30 calendar days.

The application for this proposed project is on file with the Louisiana Department of Environmental Quality and may be examined during weekdays between 8:00 a.m. and 4:30 p.m. Copies may be obtained upon payment of costs of reproduction.

### **Corps of Engineers Permit Criteria**

The decision whether to issue a permit will be based on an evaluation of the probable impacts, including cumulative impacts of the proposed activity on the public interest. That decision will reflect the national concern for both protection and utilization of important resources. The benefit which reasonably may be expected to accrue from the proposal must be balanced against its reasonably foreseeable detriments. All factors which may be relevant to the proposal will be considered including the cumulative effects thereof; among those are conservation, economics, aesthetics, general environmental concerns, wetlands, historic properties, fish and wildlife values, flood hazards, floodplain values, land use, navigation, shoreline erosion and accretion, recreation, water supply and conservation, water quality, energy needs, safety, food and fiber production, mineral needs, considerations of property ownership and, in general, the needs and welfare of the people.

The US Army Corps of Engineers is soliciting comments from the public, federal, state, and local agencies and officials, Indian Tribes, and other interested parties in order to consider and evaluate the impacts of this proposed activity. Any comments received will be considered by the US Army Corps of Engineers to determine whether to make, modify, condition, or deny a permit for this proposal. To make this decision, comments are used to assess impacts on endangered species, historic properties, water quality, general environmental effects, and other public interest factors listed above. Comments are used in the preparation of an Environmental Assessment and/or an Environmental Impact Statement pursuant to the National Environmental Policy Act. Comments are also used to determine the need for a public hearing and to determine the overall public interest of the proposed activity.

The New Orleans District is unaware of properties listed on the National Register of Historic Places near the proposed work. The possibility exists that the proposed work may damage or destroy presently unknown archeological, scientific, prehistorical, historical sites, or data. Copies of this notice are being sent to the State Archeologist and State Historic Preservation Officer.

Our initial finding is that the proposed work would neither affect any species listed as endangered by the U.S. Departments of Interior or Commerce, nor affect any habitat designated as critical to the survival and recovery of any endangered species. Utilizing Standard Local Operating Procedure for Endangered Species in Louisiana (SLOPES), dated October 22, 2014, between the U.S. Army Corps of Engineers, New Orleans and U.S. Fish and Wildlife Service, Ecological Services Office, the Corps has determined that the proposed activity would have no effect on any listed species.

This notice initiates the Essential Fish Habitat (EFH) consultation requirements of the Magnuson-Stevens Fishery Conservation and Management Act. The applicant's proposal would result in the destruction or alteration of 0 acres of EFH utilized by various life stages of red drum and penaeid shrimp. Our initial determination is that the proposed action would not have a substantial adverse impact on EFH or federally managed fisheries in the Gulf of Mexico. Our final determination relative to project impacts and the need for mitigation measures is subject to review by and coordination with the National Marine Fisheries Service.

If the proposed work involves deposits of dredged or fill material into navigable waters, the evaluation of the probable impacts will include the application of guidelines established by the Administrator of the Environmental Protection Agency. Also, a certification that the proposed activity will not violate applicable water quality standards will be required from the Department of Environmental Quality, Office of Environmental Services, before a permit is issued.

The applicant has certified that the proposed activity described in the application complies with and will be conducted in a manner that is consistent with the Louisiana Coastal Resources Program. The Department of the Army permit will not be issued unless the applicant received approval or a waiver of the Coastal Use Permit by the Department of Natural Resources.

Any person may request, in writing, within the comment period specified in this notice, that a public hearing be held to consider this application. Requests for public hearings shall state, with particularity, the reasons for holding a public hearing. You are requested to communicate the information contained in this notice to any other parties whom you deem likely to have interest in the matter.

JOHN M. HERMAN  
Chief, Central Evaluation Section  
Regulatory Branch

Enclosure

# Louisiana Office of State Lands

0010/355017

Vicinity Map





# SONRIS<sup>NG</sup> Interactive Maps - Oil/Gas

Louisiana Department of Natural Resources

Show Coordinates

St  
Mary

BAYOU CHENE

(-91.116482,29.615817)

DIVISION OF STATE LANDS - PATENT

T17S - R13E

Terr

10

1:8000

0.13 MILES



# Untitled Map

Write a description for your map.

## Legend

-  Feature 1
-  Feature 2
-  SLEW 2/22/2017
-  Untitled Path

Sonaris Property Line 





Property Line

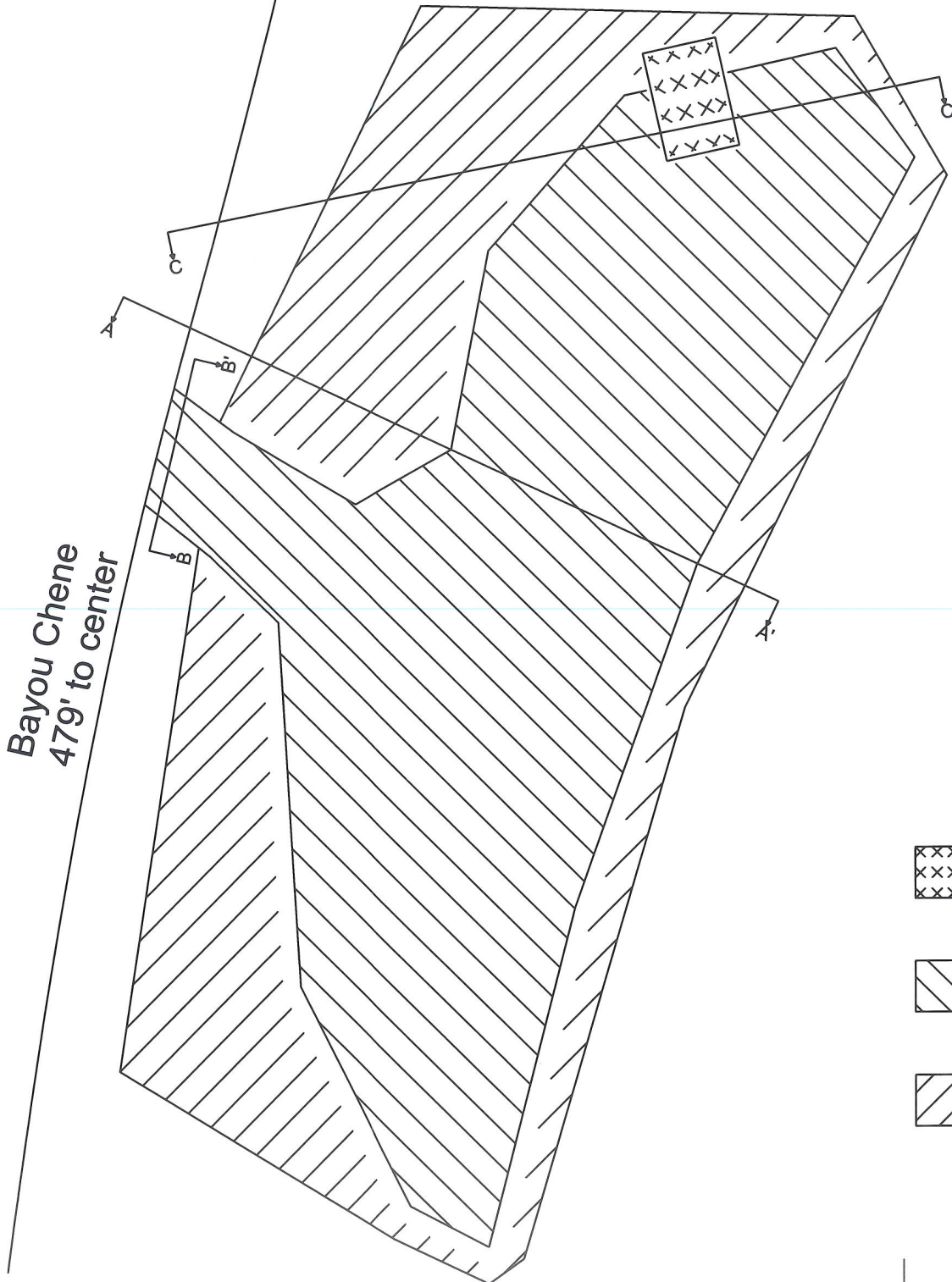

Bayou Chene  
479' to center

 Elevated Camp  
(approx. 12' off GL)  
(built on pilons)

 Dig Area  
(3,457 C.Y.)

 Fill Area  
(3,457 C.Y.)



Scale: 1" = 44'

Project Name: Camp Bayou Chene

A

A'

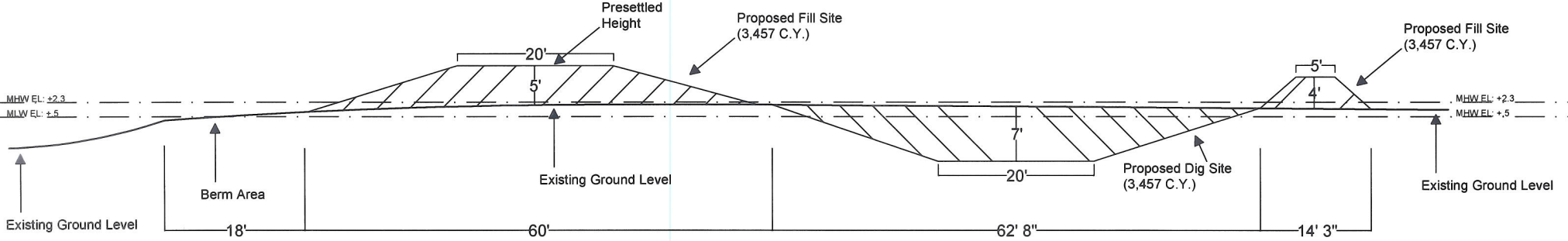

Project Name: Camp Bayou Chene

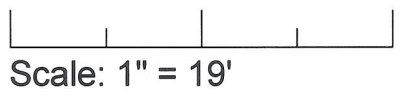



B

B'

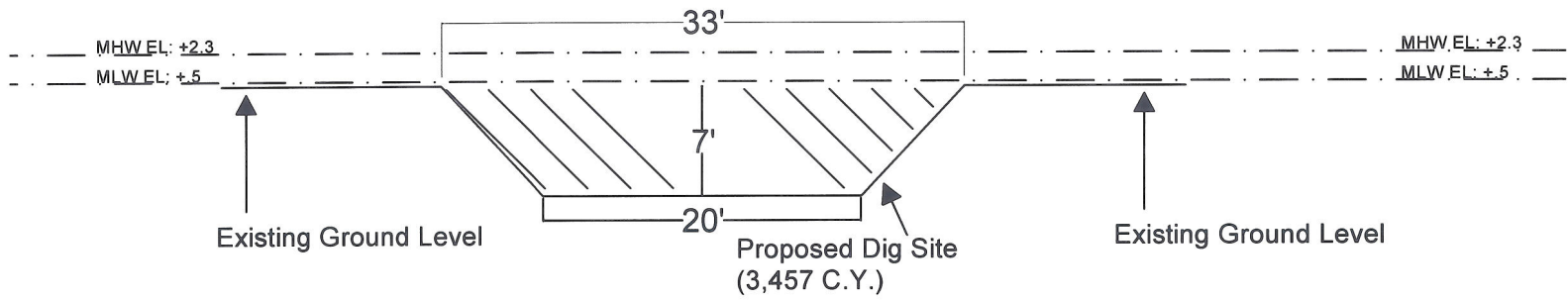

 Dig Area  
(3,457 C.Y.)

 Fill Area  
(3,457 C.Y.)



Scale: 1" = 12'

Project Name: Camp Bayou Chene

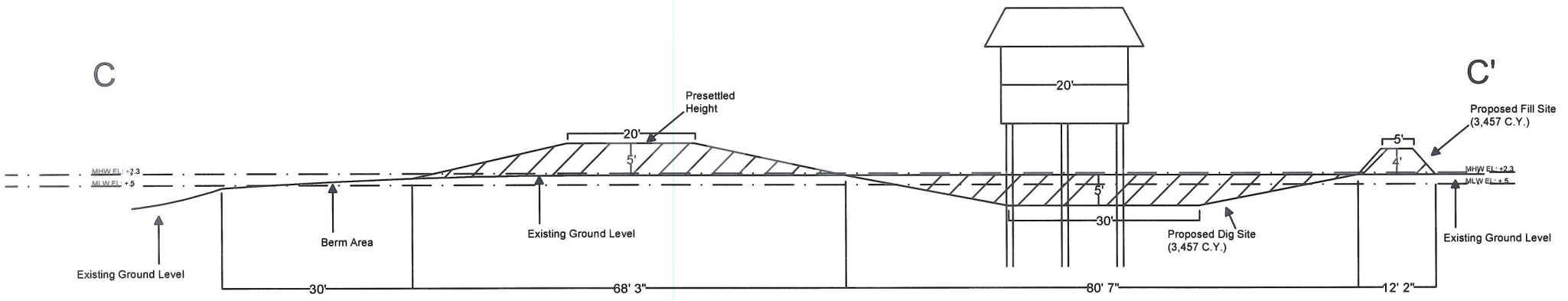

 Dig Area  
(3,457 C.Y.)

 Fill Area  
(3,457 C.Y.)

Project Name: Camp Bayou Chene

